

HEAVY DUTY
MOWER
PARTS PRICE LIST

PEO-21
1942 SERIES

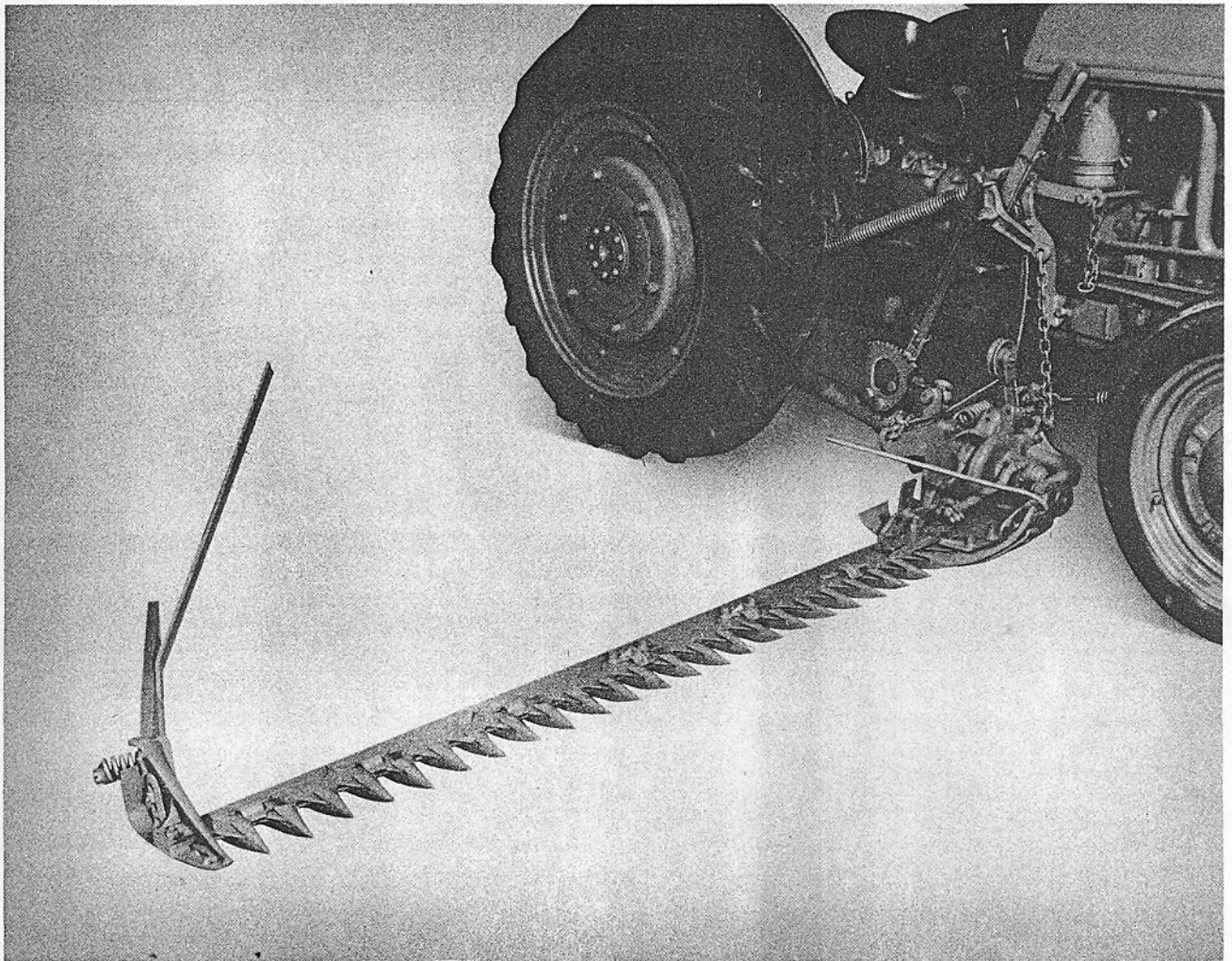

JANUARY 2, 1942

Ferguson-Sherman
MANUFACTURING CORPORATION

DEARBORN, MICHIGAN

(PRICES SUBJECT TO CHANGE WITHOUT NOTICE)

IMPLEMENT PARTS PRICE LIST

Part No.	Price	Description	5'	6'
FERGUSON HEAVY DUTY MOWER-PEO-21-CUTTER BAR PARTS				
5PEO-1205-C	X \$27.00	Cutter Bar Assembly Less Inner Shoe - 5'	1	
6PEO-1205-C	X 31.50	Cutter Bar Assembly Less Inner Shoe - 6'		1
PEO-1231-B	X .15	Knife Clip - Plain	4	5
PEO-1232	X .35	Knife Clip - Inner	1	1
355624-S		Square Neck Bolt - Guard to Bar to Clip	10	12
33792-S		Hex Nut - Guard to Bar to Clip	10	12
5PEO-1233	X 1.00	Knife Back - 5'	1	
6PEO-1233	X 1.00	Knife Back - 6'		1
PEO-1234	X 1.95	Section - Serrated (Box of 25)	20	24
PEO-1235	X 1.50	Section - Smooth (Box of 25)	20	24
60370-S		R.H. Rivet - Section to Knife Back	30	38
60454-S		R.H. Rivet - Knife Head to Reinforcement to Back	6	6
60413-S		R.H. Rivet - Knife Head to Back	7	7
PEO-1236	X 1.50	Guard Plate (Box of 25)	19	23
PEO-9722		C.S. Rivet - Guard Plate to Guard	19	23
PEO-1244	X .50	Guard and Plate Assembly - Regular	18	22
PEO-1245	X .55	Rock Guard and Plate Assembly	18	22
350690-S		Guard Bolt (Short) - Guard to Bar	9	11
355624-S		Guard Bolt (Long) - Guard to Bar to Clip	10	12
33792-S		Hex Nut - On Guard Bolt	19	23
5PEO-1250-B	X 6.50	Knife Assembly - 5' (Regular Knives)	1	
6PEO-1250-B	X 7.00	Knife Assembly - 6' (Regular Knives)		1
5PEO-1251-B	X 7.00	Knife Assembly - 5' (Serrated)	1	
6PEO-1251-B	X 7.50	Knife Assembly - 6' (Serrated)		1
PEO-1252	X .60	Rock Guard and Plate Assembly (Outer Only)	1	1
PEO-1253	X .55	Guard and Plate Assembly - Regular (Outer Only)	1	1
PEO-1254-B	X 3.25	Knife Head	1	1
60413-S		R.H. Rivet - Knife Head to Knife Back	7	7
60454-S		R.H. Rivet - Knife Head to Reinforcement to Back	6	6
PEO-3920-B	X 1.70	Inner Shoe Sole Assembly	1	1
20895-S		Hex Head Bolt - Bracket to Shoe	1	1
351436-S		Special Lock Washer - Bracket to Shoe	1	1
33792-S		Hex Nut - Bracket to Shoe	1	1
23502-S		Carriage Bolt - Sole to Inner Shoe to Grass Rod	1	1
34708-S		Flat Washer - Sole to Inner Shoe to Grass Rod	1	1
33801-S		Hex Nut - Sole to Inner Shoe to Grass Rod	1	1
PEO-3923-B	X 17.50	Inner Shoe Assembly	1	1
350719-S		Carriage Bolt - Bar to Shoe	2	2
351500-S		Lock Washer - Bar to Shoe	2	2
33806-S		Hex Nut - Bar to Shoe	2	2
20879-S		Hex Head Bolt - Lever to Inner Shoe	3	3
33792-S		Hex Nut - Lever to Inner Shoe	3	3
351436-S		Special Lock Washer - Lever to Inner Shoe	3	3
PEO-3927-B	X .30	Ledger Plate - Inner Shoe	1	1
62279-S		C.S. Rivet - Ledger Plate to Inner Shoe	4	4
PEO-3930	X .90	Outer Sole Assembly	1	1
23440-S		Carriage Bolt - Outer Shoe to Sole	1	1
33799-S		Hex Nut - Outer Shoe to Sole	1	1
34807-S		Lock Washer - Outer Shoe to Sole	1	1
5PEO-3941-B	X 8.75	Finger Bar - 5'	1	
6PEO-3941-B	X 9.50	Finger Bar - 6'		1
PEO-3943	X .15	Wearing Plate - Knife Clip	5	6
PEO-3945-B	X .60	Wear Plate - Rear Knife Guide	1	1
350719-S		Carriage Bolt - Bar to Shoe	2	2
351500-S		Lock Washer - Bar to Shoe	2	2
33806-S		Hex Nut - Bar to Shoe	2	2
PEO-3946	X .10	Wearing Plate - Outer Shoe	1	1
62303-S		C.S. Rivet (Short) - Plate to Shoe	1	1
62357-S		C.S. Rivet (Long) - Plate to Shoe	1	1
PEO-3947	X 2.40	Outer Shoe with Plate	1	1
355624-S		Square Neck Plow Bolt - Outer Shoe to Bar	2	2
351436-S		Special Lock Washer - Outer Shoe to Bar	2	2
33792-S		Hex Nut - Outer Shoe to Bar	2	2

X Special Discount

IMPLEMENT PARTS PRICE LIST

Part No.	Price	Description	5'	6'
FERGUSON HEAVY DUTY MOWER-PEO-21-CUTTER BAR PARTS (Continued)				
PEO-3949	X\$ 1.00	Cap - Inner Shoe	1	1
20872-S		Hex Head Bolt - Cap to Inner Shoe	2	2
351436-S		Special Lock Washer - Cap to Inner Shoe	2	2
PEO-3954-B	X .50	Grass Rod	1	1
23502-S		Carriage Bolt - Sole to Inner Shoe to Grass Rod	1	1
34708-S		Flat Washer - Sole to Inner Shoe to Grass Rod	1	1
33801-S		Hex Nut - Sole to Inner Shoe to Grass Rod	1	1
PEO-3955-B	X 4.00	Grass Stick	1	1
PEO-9669		U-Bolt - Grass Stick to Swathboard	1	1
33798-S		Hex Nut - Grass Stick to Swathboard	2	2
23408-S		Carriage Bolt - Grass Stick to Swathboard	1	1
33797-S		Hex Nut - For Carriage Bolt	1	1
34806-S		Lock Washer - For Above Bolts	3	3
PEO-7022	.30	Spring - Swathboard	1	1
PEO-7916	.20	Brace - Swathboard	1	1
PEO-7982-B	X 4.00	Swathboard	1	1
PEO-8042-C	X .75	Front Knife Guide	1	1
23502-S		Carriage Bolt - Front Knife Guide to Shoe	2	2
PEO-9705		Front Knife Guide Shim		
351436-S		Special Lock Washer - Front Knife Guide to Shoe	2	2
33801-S		Hex Nut - Front Knife Guide to Shoe	2	2
PEO-8043-B	X .65	Rear Knife Guide	1	1
350719-S		Carriage Bolt - Rear Knife Guide to Shoe	2	2
PEO-9702		Rear Knife Guide Shim		
351500-S		Lock Washer - Rear Knife Guide to Shoe	2	2
33806-S		Hex Nut - Rear Knife Guide to Shoe	2	2
PEO-9752	X .35	Reinforcement - Knife Back	1	1
60454-S		R.H. Rivet - Knife Head to Reinforcement to Back	6	6

X Special Discount

MOWER
HEAVY DUTY

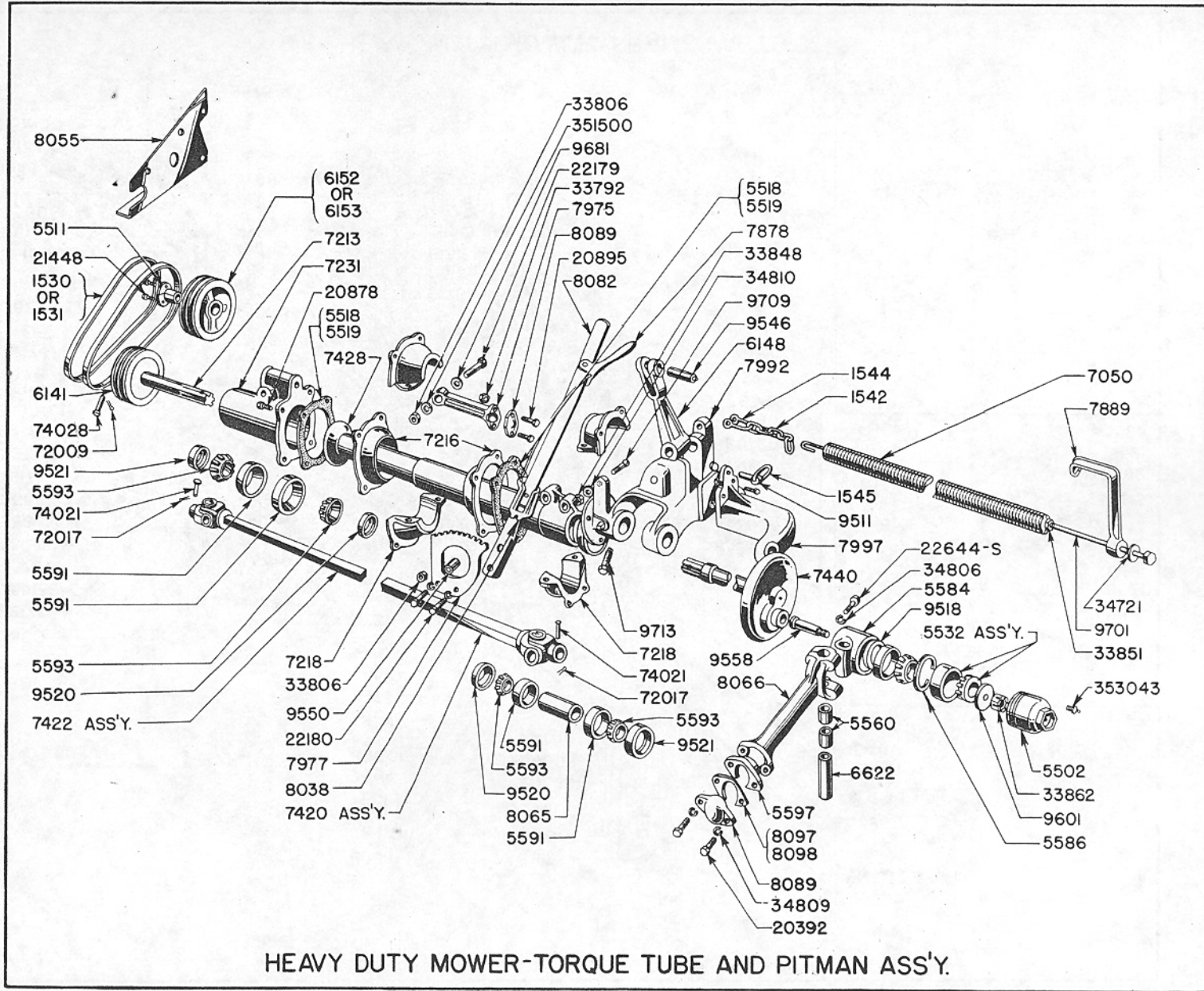

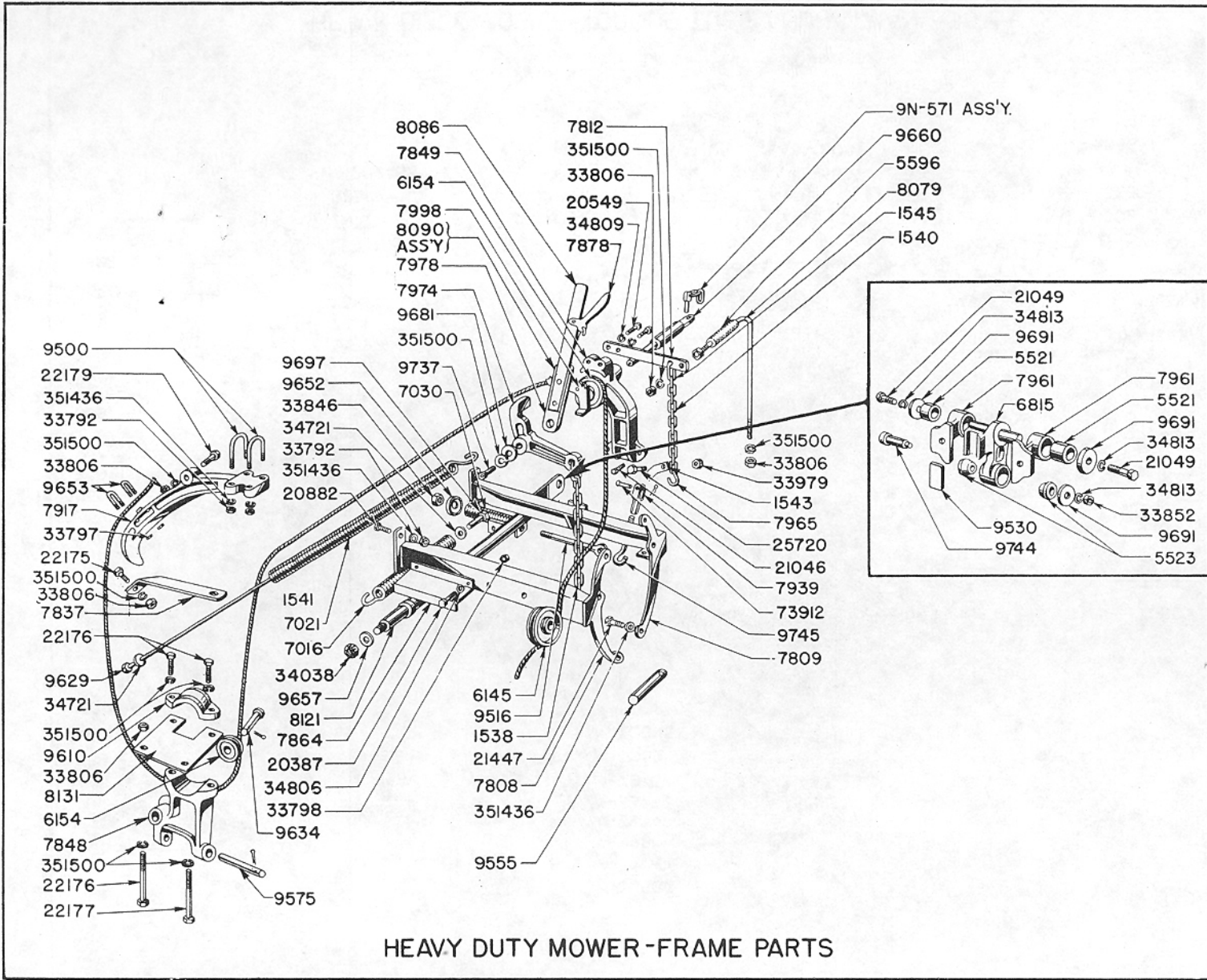

HEAVY DUTY MOWER-FRAME PARTS

IMPLEMENT PARTS PRICE LIST

IMPLEMENT PARTS PRICE LIST

Part No.	Price	Description	Unit
FERGUSON HEAVY DUTY MOWER-PEO-21-FRAME PARTS			
PEO-50	\$ 8.00	Curb Lever Attachment	1
PEO-1530	3.45	V-Belt - 56" (Use with 9-3/4" Diameter Pulley)	2
PEO-1531	2.85	V-Belt - 54" (Use with 8-1/2" Diameter Pulley)	2
PEO-1535-B	.10	Chain - Inner Shoe Lever (2 Links)	1
PEO-1538	.40	Chain - Hinge Balance (12 Links)	1
PEO-1540	.45	Chain - Safety (13 Links)	1
PEO-1541	3.00	Cable - Elevating	1
PEO-1542	.15	Chain - Pull Spring	1
PEO-1543	.15	Link - Clutch Throwout	1
PEO-1544	.75	Clevis - Pull Spring Chain	1
PEO-1545	.10	Repair Link	-
PEO-3958-B	2.50	Lever - Inner Shoe	1
20879-S		Hex Head Bolt - Lever to Inner Shoe	3
351436-S		Special Lock Washer - Lever to Inner Shoe	3
33792-S		Hex Nut - Lever to Inner Shoe	3
PEO-5502-B	1.00	Dust Cap - Pitman	1
PEO-5511	X 4.00	Bushing - V-Pulley	1
21448-S		Hex Head Bolt - Bushing to Pulley	3
351436-S		Special Lock Washer - Bushing to Pulley	3
PEO-5518	.10	Gasket (.015) - U-Joint Housing	-
PEO-5519	.15	Gasket (.030) - U-Joint Housing	-
PEO-5520-B	.07	Cork Gasket - U-Joint	-
PEO-5521	1.25	Rubber Bushing - Straight	2
PEO-5523	1.00	Rubber Bushing - Tapered	2
PEO-5532	1.50	Roller Bearing - Pitman Box	2
PEO-5541	.10	3/4-14 Pipe Plug (In Hinge Casting)	2
PEO-5544-B	.60	Bearing Assembly - U-Joint	8
PEO-5560	.25	Bushing - Pitman Box	2
PEO-5584-B	X 3.00	Pitman Box with Bushing	1
PEO-5586	.20	Lock Ring	1
PEO-5591	.60	Race - Roller Bearing	4
PEO-5593	1.40	Cone - Roller Bearing	4
PEO-5596	.10	Insulator Tube	1
PEO-5597	.90	Pitman Ball Cap (Inside)	1
20392-S		Hex Head Bolt - Pitman Ball Caps to Pitman Arm	2
34809-S		Lock Washer - Pitman Ball Caps to Pitman Arm	2
PEO-6141	6.50	V-Pulley - 5-5/8" Diameter (Driven Pulley)	1
74028-S		Clevis Pin - Pulley	1
72009-S		Cotter Pin - In Pulley Clevis Pin	1
PEO-6143	X 7.50	V-Pulley less Bushing (8-1/2" Diameter) - Low Speed	1
PEO-6144	X 8.50	V-Pulley less Bushing (9-3/4" Diameter) - High Speed	1
PEO-6145	2.00	Pulley - Cable	1
PEO-6148-B	2.65	Bracket - Cable Pulley	1
PEO-9546		Cable Pulley Pin	1
PEO-9555		Pin - Cable Pulley Bracket to Hinge	1
PEO-6152	X 11.75	V-Pulley (Low Speed)	1
PEO-6153	X 12.75	V-Pulley (High Speed)	1
PEO-6154	2.00	Sheave - Cable	1
PEO-9634-B		Pin - Cable Sheave	1
PEO-6161-B	1.50	U-Joint Journal	2
PEO-6622	.80	Wrist Pin	1
PEO-6815	4.00	Arm - Drag Bar	1
PEO-9744		Bolt - Drag Bar to Arm	1
34813-S		Lock Washer - Drag Bar to Arm	1
33852-S		Hex Nut - Drag Bar to Arm	1
PEO-7016	3.00	Cross Balance Spring with Plug	1
PEO-7021	3.00	Balance Spring with Plug	1
PEO-7030-B	.25	Spring - Clutch Throwout	1
PEO-7048	.05	Spring - Plunger Lever	1
PEO-7050-B	4.00	Pull Spring with Plug	1
PEO-7051-A	1.00	Plug - Spring	2
PEO-7051-B	1.00	Plug - Spring	1

X Special Discount

MOWER
HEAVY DUTY

IMPLEMENT PARTS PRICE LIST

Part No.	Price	Description	Unit
FERGUSON HEAVY DUTY MOWER-PEO-21 -FRAME PARTS (Continued)			
PEO-7063	\$.18	Spring - Curb Lift Lever Pawl	1
PEO-7213-B	6.50	Shaft - Pulley Housing	1
PEO-7216	1.50	Cap - U-Joint Housing (Inner)	2
PEO-7218	1.50	Cap - U-Joint Housing (Outer)	4
20878-S		Hex Head Bolt - Caps to Pulley Housing and to Hinge	8
351436-S		Special Lock Washer - Caps to Pulley Housing and to Hinge ...	8
33792-S		Hex Nut - Caps to Pulley Housing and to Hinge	8
PEO-7231	10.50	Housing - Pulley	1
PEO-9575-B		Pin - Pulley Housing to Support Bracket	1
PEO-9613		Adjusting Screw - In Pulley Housing	1
33806-S		Hex Nut - Jam Nut for PEO-9613	1
353035-A1-3		Zerk Fitting - In Pulley Housing	1
PEO-7420-B	15.00	Drive Shaft and U-Joint Assembly (Lower)	1
74021-S		Clevis Pin - U-Joint to Pitman Crankshaft	1
72017-S		Cotter Pin - In Clevis Pin	1
PEO-7422-B	18.50	Drive Shaft and U-Joint Assembly (Upper)	1
PEO-7428-C	25.50	Ball Seat and Tube Assembly	1
PEO-7440-B	X 8.50	Crankshaft and Flywheel Assembly (Less Pitman Pin)	1
PEO-7808-B	9.75	Frame - R.H.	1
PEO-7809-B	10.00	Frame - L.H.	1
20882-S		Hex Head Bolt - Frame to Tractor (Rear)	4
351436-S		Special Lock Washer - Frame to Tractor (Rear)	4
33792-S		Hex Nut - Frame to Tractor (Rear)	4
21447-S		Hex Head Bolt - Frame to Tractor (Front)	6
PEO-7812	.60	Bracket - Brace Rod	1
20549-S		Hex Head Bolt - Bracket to Pedestal	2
34809-S		Lock Washer - Bracket to Pedestal	2
33846-S		Hex Nut - Bracket to Pedestal	2
PEO-7837	1.00	Brace - Hitch	1
22175-S		Hex Head Bolt - Brace to Lower Draw Bar Stay	1
351500-S		Lock Washer - Brace to Lower Draw Bar Stay	1
33806-S		Hex Nut - Brace to Lower Draw Bar Stay	1
PEO-7844	.15	Cable Clamp	1
PEO-7848-B	5.35	Bracket - Pulley Housing Support	1
22176-S		Hex Head Bolt - Clamp Bracket to Pulley Housing Support	2
351500-S		Lock Washer - Clamp Bracket to Pulley Housing Support	2
33806-S		Hex Nut - Clamp Bracket to Pulley Housing Support	2
PEO-7849-B	8.00	Pedestal	1
21046-S		Hex Head Bolt - Pedestal to Frame	2
33849-S		Hex Nut - Pedestal to Frame	2
PEO-7856	1.00	Pawl - Curb Lift Lever	1
PEO-7864	.65	Shield - Exhaust Pipe	1
20387-S		Hex Head Bolt - Shield to Frame	2
34806-S		Lock Washer - Shield to Frame	2
33798-S		Hex Nut - Shield to Frame	2
PEO-7878	.15	Lever - Handle Grip	2
PEO-7889	1.25	Bracket - Pull Spring	1
PEO-7917-B	4.25	Extension - Elevating Lever	1
22179-S		Hex Head Bolt - Extension Lever to Tractor Lift Arm	1
351500-S		Lock Washer - Extension Lever to Tractor Lift Arm	1
33806-S		Hex Nut - Extension Lever to Tractor Lift Arm	1
PEO-9500		U-Bolt - Extension Lever to Tractor Lift Arm	2
351436-S		Special Lock Washer - Extension Lever to Tractor Lift Arm ...	2
33792-S		Hex Nut - Extension Lever to Tractor Lift Arm	2
PEO-7939	.45	Yoke - Clutch Throwout	1
PEO-7961	2.25	Bracket - Drag Bar	2
21049-S		Hex Head Bolt - Bracket to Frame	2
34813-S		Lock Washer - Bracket to Frame	2
33852-S		Hex Nut - Bracket to Frame	2
PEO-7965-B	.25	Hook - Safety Chain	1
PEO-7966-B	.65	Safety Chain	1
PEO-7974-B	2.00	Counterbalance Lever	1
PEO-7975	2.00	Link - Tilt	1

X Special Discount

IMPLEMENT PARTS PRICE LIST

Part No.	Price	Description	Unit
FERGUSON HEAVY DUTY MOWER-PEO-21 - FRAME PARTS (Continued)			
20895-S		Hex Head Bolt - Cap to Tilt Link	2
33792-S		Hex Nut - Cap to Tilt Link	2
22179-S		Hex Head Bolt - Tilt Link to Adjusting Lever	1
351500-S		Lock Washer - Tilt Link to Adjusting Lever	1
33806-S		Hex Nut - Tilt Link to Adjusting Lever	1
PEO-7977	\$ 1.00	Ratchet Plate (For Tilt Lever)	1
22180-S		Hex Head Bolt - Ratchet Plate to Ball Seat Bracket	2
351500-S		Lock Washer - Ratchet Plate to Ball Seat Bracket	2
33806-S		Hex Nut - Ratchet Plate to Ball Seat Bracket	2
PEO-7978	1.75	Curb Lift Lever End	1
PEO-7992-C	26.75	Hinge Casting (With Bearing Races and Hinge Tube)	1
PEO-7997	4.00	Bracket - Hinge Bearing	1
25691-S		Hex Head Bolt - Bracket to Hinge	3
351436-S		Special Lock Washer - Bracket to Hinge	3
33820-S		Hex Nut (Slotted) - Bracket to Hinge	3
25724-S		Hex Head Bolt - Bracket to Hinge	1
351500-S		Lock Washer - Bracket to Hinge	1
33862-S		Hex Nut (Slotted) - Bracket to Hinge	1
PEO-7998-B	1.00	Ratchet - Curb Lift	1
PEO-8038	.35	Tilting Lever Latch	1
PEO-8055-B	1.75	Pulley Belt Guard Assembly	1
PEO-8065	1.30	Tube - Hinge	1
PEO-8066-B	X 2.70	Pitman Rod (Less Caps)	1
PEO-8079	1.10	Brace Rod	1
PEO-8082	4.40	Lever - Tilt Adjusting	1
PEO-8086	1.75	Lever - Curb Lift	1
PEO-8089	.90	Cap - Ball (Pitman and Tilt Link)	2
PEO-8090	6.75	Curb Lift Lever Assembly	1
PEO-8097	.05	Shim (.005) - Tilt Ball Socket and Pitman Ball Cap	-
PEO-8098	.05	Shim (.010) - Tilt Ball Socket and Pitman Ball Cap	-
PEO-8118-B	2.75	Yoke - U-Joint (Splined)	2
PEO-8121-B	11.00	Drag Bar Assembly	1
PEO-8131	1.60	Plate - Pulley Housing Support Bracket	1
22176-S		Hex Head Bolt - Plate to Tractor	1
22177-S		Hex Head Bolt - Plate to Tractor	1
351500-S		Lock Washer - Plate to Tractor	2
33806-S		Hex Nut - Plate to Tractor	2
PEO-9500	.40	U-Bolt - Elevating Lever Extension	2
PEO-9511	.85	Eyebolt - Hinge Balance Chain	1
PEO-9516	.60	Eyebolt - Clutch Throwout	1
PEO-9518	.95	Oil Seal - Pitman Box	1
PEO-9519	.10	Cork Seal - U-Joint Housing Cap	2
PEO-9520	.15	Oil Shield	2
PEO-9521	.45	Oil Seal	2
PEO-9530	.30	Block - Rubber Stop	1
PEO-9546	1.00	Pin - Cable Pulley	1
PEO-9550	.25	Spacer - Tilt Lever (Large)	1
PEO-9551	.30	Spacer - Tilt Lever (Small)	1
PEO-9555	.80	Pin - Cable Pulley Bracket to Hinge	1
PEO-9558-B	X 1.50	Pitman Pin	1
PEO-9565-B	1.50	Hinge Pin	1
PEO-9566	.35	Spacer - Pedestal Pin	1
PEO-9575-B	.85	Pin - Pulley Housing	1
PEO-9601	.01	Washer - Pitman Adjusting	1
PEO-9604	.20	Thimble - Cable	1
PEO-9610-B	.95	Clamp Bracket	1
PEO-9611	.10	Shim (7/16 x 15/16 x 1/32)	-
PEO-9613	.30	Adjusting Screw - Pulley Housing	1
PEO-9616-B	.15	Bolt - Swathboard to Outer Shoe (Sq. Hd. 1/2-13 x 4.25)	1
PEO-9629	1.50	Adjusting Bolt - Balance Spring	1
PEO-9634-B	1.40	Pin - Cable Sheave	1
PEO-9647	.05	Shim (.0306) - Drive Shaft	-
PEO-9652	.07	Washer - Clutch Throwout Spring	1

X Special Discount

MOWER
HEAVY DUTY

IMPLEMENT PARTS PRICE LIST

Part No.	Price	Description	Unit
FERGUSON HEAVY DUTY MOWER-PEO-21 -FRAME PARTS (Continued)			
PEO-9653	\$.10	U-Bolt - Cable Clamp	2
PEO-9657	.08	Flat Washer (1-1/3 x 1-3/4 x 1/8) - Drag Bar	1
PEO-9658	.05	Washer - Curb Lift Lever Pawl	1
PEO-9660-C	1.50	Pin - Pedestal	1
PEO-9669	.25	U-Bolt - Grass Stick to Swathboard	1
PEO-9671	.05	Washer - Frame Bracket	1
PEO-9672	.05	Shim (.0184) - Drive Shaft	-
PEO-9673	.05	Shim (.0245) - Drive Shaft	-
PEO-9675	.05	Shim (.0368) - Drive Shaft	-
PEO-9680	.05	Shim (.0050) - Drive Shaft	-
PEO-9681	.15	Flat Washer (21/32 x 1.62 x .18) - Retainer Screw	1
PEO-9682	.08	Shim (.0184) - Crankshaft Bearing Adjusting	-
PEO-9683	.08	Shim (.0245) - Crankshaft Bearing Adjusting	-
PEO-9684	.08	Shim (.0306) - Crankshaft Bearing Adjusting	-
PEO-9685	.08	Shim (.0368) - Crankshaft Bearing Adjusting	-
PEO-9691	.32	Flat Washer (3/4 x 3.12 x .31) - Drag Bar Bracket	3
PEO-9697	1.00	Adjusting Bolt - Cross Balance Spring	1
PEO-9701-B	1.35	Adjusting Bolt - Pull Spring	1
PEO-9702	.25	Shim - Rear Knife Guide	-
PEO-9705	.10	Shim - Front Knife Guide	-
PEO-9708	.06	Shim- Wear Plate	-
PEO-9709	2.00	Ball - Tilt Link	1
PEO-9713	.20	Lock Screw - Hinge Tube	1
PEO-9722	.25#	C. S. Rivet (7/32 x 1-7/16)	-
PEO-9737-B	.20	Screw - Retainer	1
PEO-9742-B	.07	Snap Ring - U-Joint	8
PEO-9744	1.10	Bolt - Drag Bar to Drag Bar Arm	1
PEO-9745	.35	Hook - Clutch Throwout	1

STANDARD PARTS

Part No.	Price	Description	Part No.	Price	Description
20387-S	\$3.00 C	5/16-24 x 1 Hex Head Bolt	22179-S	\$.18	5/8-18 x 3-3/4 Hex Head Bolt
20392-S	.07	1/2-13 x 1 Hex Head Bolt.	22180-S	.15	5/8-18 x 3 Hex Head Bolt.
20549-S	.08	1/2-20 x 2-1/2 Hex Head Bolt	22644-S	.02	5/16-24 x 1-1/4 Hex Head Bolt (Dr. Hd.)
20872-S	.05	7/16-20 x 2 Hex Head Bolt	23408-S	.02	5/16-18 x 1 Carriage Bolt
20878-S	4.00C	7/16-20 x 1-1/4 Hex Head Bolt	23440-S	.06	3/8-16 x 1-1/4 Carriage Bolt
20879-S	.06	7/16-20 x 1-3/4 Hex Head Bolt	23502-S	.06	7/16-14 x 1-3/4 Carriage Bolt
20882-S	.06	7/16-20 x 2-1/4 Hex Head Bolt	25691-S	.07	7/16-20 x 1-3/4 Hex Head Bolt (Dr. End)
20895-S	.04	7/16-20 x 1-1/2 Hex Head Bolt	25700-S	.06	3/8-24 x 1-3/4 Hex Head Bolt (Dr. End)
21046-S	.10	5/8-11x 1-3/4 Hex Head Bolt	25724-S	.12	5/8-18 x 2 Hex Head Bolt (Dr. End)
21049-S	.23	3/4-16 x 1-3/4 Hex Head Bolt	25794-S	.15	5/8-18 x 3-1/4 Hex Head Bolt (Dr. End)
21175-S	.10	5/8-18 x 2 Hex Head Bolt.	33792-S	.05	7/16-20 Hex Nut
21447-S	.05	7/16-14 x 1-1/2 Hex Head Bolt	33797-S	.03	5/16-18 Hex Nut
21448-S	.05	7/16-14 x 1-3/4 Hex Head Bolt	33798-S	.02	5/16-24 Hex Nut
22175-S	.10	5/8-18 x 1-1/2 Hex Head Bolt	33799-S	.05	3/8-16 Hex Nut
22176-S	.60	5/8-18 x 7 Hex Head Bolt.	33801-S	.03	7/16-14 Hex Nut
22177-S	.45	5/8-18 x 5-3/4 Hex Head Bolt	33806-S	.05	5/8-18 Hex Nut
			33820-S	.05	7/16-20 Hex Nut (Slotted)
			33845-S	.05	1/2-13 Hex Nut
			33846-S	.05	1/2-20 Hex Nut

IMPLEMENT PARTS PRICE LIST

Part No.	Price	Description	Part No.	Price	Description
FERGUSON HEAVY DUTY MOWER-PEO-21-STANDARD PARTS (Continued)					
33848-S	\$.05	9/16-18 Hex Nut.....	72053-S	\$.01	1/8 x 1-1/4 Cotter Pin ..
33849-S	.06	5/8-11 Hex Nut	72071-S	.01	1/8 x 1-1/2 Cotter Pin ..
33851-S	.10	3/4-10 Hex Nut	72073-S	.01	3/16 x 1-1/2 Cotter Pin .
33852-S	.10	3/4-16 Hex Nut	72109-S	.01	3/16 x 2 Cotter Pin
33862-S	.12	5/8-18 Hex Nut (Slotted).	72111-S	.01	1/4 x 2 Cotter Pin
33979-S	.03	3/8-24 Hex Nut (Slotted).	72147-S	.01	1/4 x 2-1/2 Cotter Pin ..
33982-S	.06	1/2-13 Hex Nut (Slotted).	73912-S	.02	3/8 x .93 Clevis Pin
34038-S	.24	1-1/8-12 Hex Nut (Slotted)	74021-S	.06	3/8 x 1-7/8 Clevis Pin ..
			74028-S	.02	3/8 x 1-15/16 Clevis Pin.
34721-S	.02	5/8 x 1-3/16 x 3/32 Flat Washer	350690-S	.03	7/16-20 x 1-1/4 Sq. Neck Plow Bolt
34806-S	.25 C	5/16 Lock Washer	350719-S	.10	5/8-18 x 2-3/4 Carriage Bolt
34807-S		3/8 Lock Washer			
34809-S	.02	1/2 Lock Washer	351436-S	1.30 C	7/16 Special Lock Washer.
34810-S		9/16 Lock Washer	351500-S	1.30 C	5/8 Lock Washer
34813-S	.03	3/4 Lock Washer	351504-S	.08	5/8 x 1-1/2 x .18 Flat Washer
60140-S	.02	3/8 x 7/8 Flat Hd. Rivet.	351505-S	.06	5/8 x 1-1/4 x 5/32 Flat Washer
60334-S	.02	5/16 x 3/8 R.H. Rivet ...			
60370-S	.25 #	7/32 x 9/16 R.H. Rivet ..	353024-S	.12	Zerk Fitting - 1/8 Pipe (45° Angle)
60413-S	.25 #	7/32 x 3/4 R.H. Rivet ...			
60454-S	.25 #	7/32 x 15/16 R.H. Rivet .	353035-A1-S	.12	Zerk Fitting - 1/4-28 (45° Angle)
60954-S	.01	5/32 x 5/8 O.H. Rivet ...	353043-A1-S	.12	Zerk Fitting - 1/4-28 (Straight)
60981-S	.01	1/4 x 3/4 O.H. Rivet	355624-S	.06	7/16-20 x 1.7 Sq. Neck Plow Bolt
61089-S	.01	1/4 x 1-1/2 O.H. Rivet ..			
62279-S	.01	3/16 x 3/4 C.S. Rivet ...			
62303-S	.01	3/16 x 7/8 C.S. Rivet ...			
62357-S	.01	3/16 x 1-13/16 C.S. Rivet			
72017-S	.01	1/8 x 3/4 Cotter Pin			

MOWER
HEAVY DUTY